



Specifications

- Shallow well jet pump
- Maximum working pressure: 6 bar
- Maximum liquid temperature: 45 °C

Materials

- Pump casing: 304 Stainless Steel
- Impeller: 304 Stainless Steel
- Jet & Diffuser: Noryl
- Shaft: 303 Stainless Steel (wetted part)
- Bracket & Motor Frame: Aluminium
- Mechanical Seal: Carbon/Ceramic/NBR

Motor Data

- TEFC, 2 pole, 50 Hz
- Insulation class F
- IP55 protection
- 1 Phase - 230 Volt
- Automatic thermal overload protection

Range

- 25 mm Ø discharge
- 0.6 to 1.1 kW - 1 Phase

Supply

- 1.8 m cable with 3 pin plug

Options

- Available as a pressure system with Presscontrol® or pressure switch

Stainless steel jet pumps for the boosting or transfer of water, small scale irrigation, tank & pool emptying, etc. Suitable for installations with suction lift.

Performance Curve

Synchronous Speed: **3000 rpm**

Water temp: **20 °C**

Applicable standard of test : **ISO 9906 Annex A**

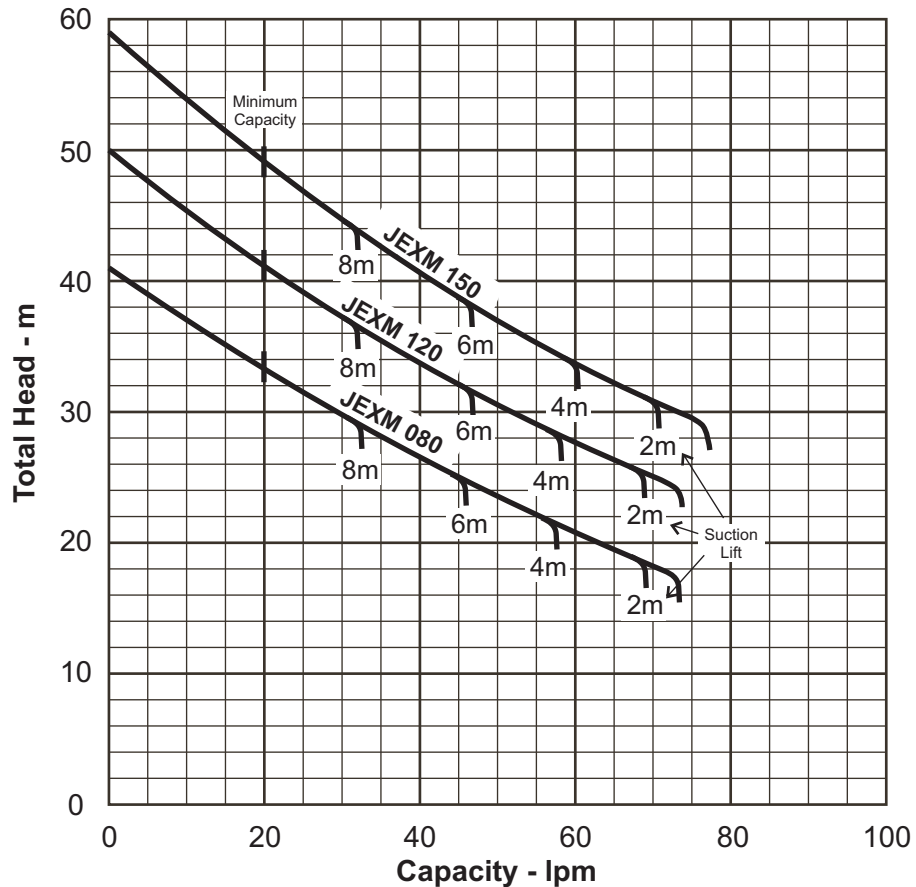

Model Code

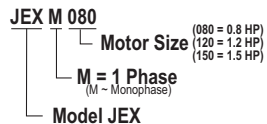

Performance Table

| Pump Model | Motor Output | Power Supply | Capacitor µF | Vc | Full Load Current | Capacity - lpm | | | | | | | |
|-----------------|--------------|--------------------|-----------------|--------|-------------------|----------------|------|------|------|------|------|------|--|
| | | | | | | 20 | 30 | 40 | 50 | 60 | 75 | | |
| JEXM 080 | 0.60 kW | 230 V, 50 Hz, 1 PH | 16 µF | 450 Vc | 4.7 A | 33 | 29 | 26.5 | 23.5 | 20.5 | 18 | | |
| JEXM 120 | 0.88 kW | 230 V, 50 Hz, 1 PH | 20 µF | 450 Vc | 6.7 A | 41 | 37 | 34 | 30.5 | 27.5 | 24.5 | | |
| JEXM 150 | 1.10 kW | 230 V, 50 Hz, 1 PH | 31.5 µF | 450 Vc | 7.6 A | 49 | 44.5 | 40.5 | 37 | 34 | 31 | 29.5 | |

Sectional Drawing

Model JEX

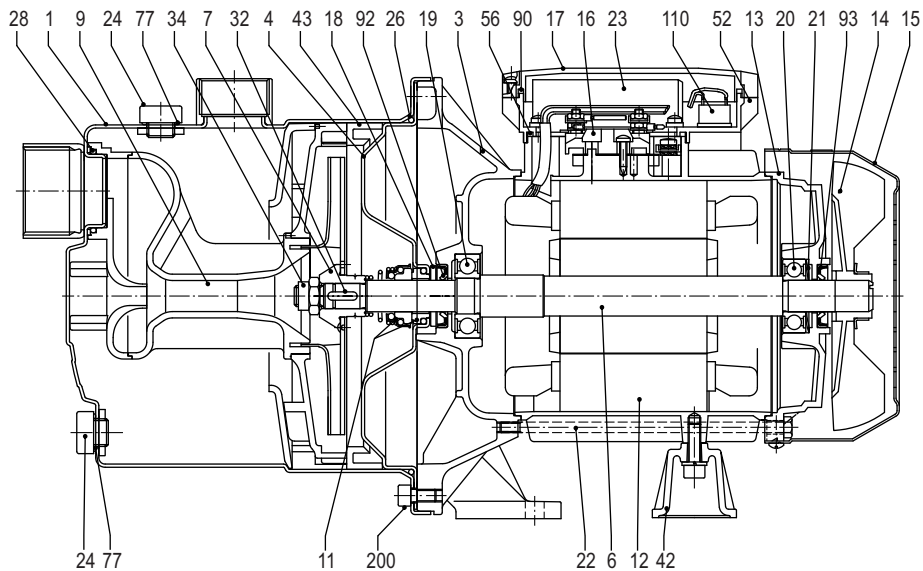

| No. | Description | Material | Qty. | No. | Description | Material | Qty. |
|-----|-------------------------|---|------|-----|--------------------|----------------------------|------|
| 1 | Casing | 304 Stainless Steel | 1 | 22 | Tie rod | Fe 420 (Gal) | |
| 3 | Motor bracket | Aluminium | 1 | 23 | Capacitor | - | 1 |
| 4 | Casing cover | 304 Stainless Steel | 1 | 24 | Priming/Drain plug | Nylon | 2 |
| 6 | Shaft with rotor | 303 Stainless Steel (Part in contact with liquid) | 1 | 26 | O-Ring | NBR | 1 |
| 7 | Impeller | 304 Stainless Steel | 1 | 28 | O-Ring | NBR | 1 |
| 9 | Diffuser/Venturi tube | PPE + PS Glass Fibre | 1 | 32 | Impeller key | 304 Stainless Steel | 1 |
| 11 | Mechanical seal | Carbon/Ceramic/NBR | 1 | 34 | Impeller nut | 304 Stainless Steel | 1 |
| 12 | Motor frame with stator | - | 1 | 42 | Motor support | Aluminium | 1 |
| 13 | Motor cover | Aluminium | 1 | 43 | Space diffuser | Noryl | 1 |
| 14 | Fan | Polyamide | 1 | 52 | Terminal box | ABS | 1 |
| 15 | Fan cover | Fe P04 (Gal) | 1 | 56 | Box gasket | NBR | 1 |
| 16 | Terminal block | - | 1 | 77 | O-Ring | NBR | 2 |
| 17 | Terminal box cover | ABS | 1 | 90 | Cover gasket | NBR | 1 |
| 18 | Splash ring | NBR | 1 | 92 | Lip seal | - | 1 |
| 19 | Pump side ball bearing | - | 1 | 93 | Lip seal | - | 1 |
| 20 | Fan side ball bearing | - | 1 | 110 | Motor protector | - (Only for JEXM 150) | 1 |
| 21 | Adjusting ring | Steel C70 | 1 | 200 | Screw | Stainless Steel A2 UNI7323 | 8 |

Dimensions

Model JEX

Units: mm unless otherwise specified

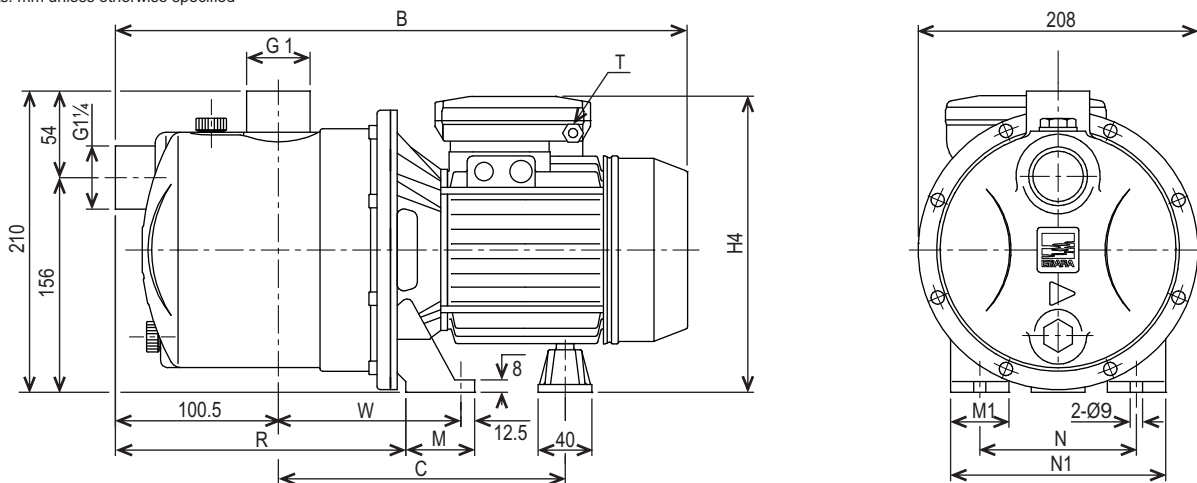

| Model | Dimensions | | | | | | | | | | Approx. Weight kg |
|----------|------------|-----|-----|----|----|-----|-----|-------|--------|-------|-------------------|
| | B | C | H4 | M | M1 | N | N1 | R | T | W | |
| JEXM 080 | 417 | 230 | 215 | 50 | 38 | 120 | 160 | 206 | PG11 | 143 | 11 |
| JEXM 120 | 417 | 230 | 215 | 50 | 38 | 120 | 160 | 206 | PG11 | 143 | 12 |
| JEXM 150 | 445 | 250 | 240 | 55 | 40 | 140 | 180 | 203.5 | PG13.5 | 145.5 | 15 |

Specifications subject to change without notice



EBARA PUMPS AUSTRALIA PTY. LTD.

Data Sheet
JEX 13-03